

# VIEW CAMERA SPIRIT LEVEL KIT

**ONLY \$12.95 PER KIT**  
plus \$4.30 Shipping



The View Camera Spirit Level kit is designed as a replacement or for the addition of a precision level to a wooden field camera. Precise leveling of the back

of the view camera (both left to right and front to back) is a must for making images with correct perspective. If you own an older camera with the swinging pointer-type mechanism, or if you have a broken level, you need a suitable, accurate replacement. For two axis leveling on camera backs without levels, you will need two kits, one for left to right and one for front to back.



This kit contains a precision spirit level vial, beautiful custom machined, hand lacquered, brushed brass cover plate and miniature round head brass screws. In the typical installation, the level vial is protected in a clean, attractive, easy to use, as well as functional manner.

This is the same precision spirit level vial used by the major manufacturers of modern wooden view cameras. The fluid is Yellow Methanol with a bubble size of 0.220" to 0.240" with two 0.010" wide reference marks.

## PRECISION SPIRIT LEVEL VIAL SPECIFICATIONS

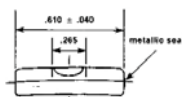

LENGTH = 0.610"  
DIAMETER = 0.236"  
NOMINAL SENSITIVITY = 50 min. (0.100" +/- 5')

## COVER PLATE DIMENSIONS

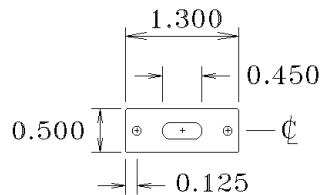

## **KIT CONTAINS THE FOLLOWING:**

- 1ea. Precision Spirit Level Vial
- 1ea. Lacquered, Brushed Brass Cover Plate
- 2ea. #1 x 1/4" Brass Wood Screws

**PLEASE NOTE:** Installation requires additional tools and a good knowledge of basic wood working technique. . . For a new installation, you will be required to route an appropriate opening to accommodate the level vial and drill holes for the screws. . . you will also need clear silicone glue to hold the level vial in place. . . you must also have an accurate reference level to adjust the accuracy of the new installation. . .

## **NEED REPLACEMENT VIALS?**



**Precision level vials are available  
separately for \$4.00 each,  
plus \$4.30 shipping.**

Shipping is via USPS Priority Mail with Delivery Confirmation. Multiple Level Kit orders are \$4.30 shipping up to and including 24 kits.

To order additional kits or level vials,  
send check or money order to:

**J.B. HARLIN  
P.O. BOX 26994  
BENBROOK, TX 76126**

[www.jbhphoto.com](http://www.jbhphoto.com)  
©2002 all rights reserved

---

---

# SUGGESTIONS FOR INSTALLING THE VIEW CAMERA SPIRIT LEVEL KIT

---

---

## TOOLS REQUIRED:

- Router, Dremel<sup>®</sup> Tool, or Chisel (for making a suitable opening for the level vial)
- 0.0625" (1/16") Drill Bit
- Small Screw Driver
- Accurate Reference Level
- Clear Silicon Glue
- Suitable, Flat Working Surface

If you are adding levels to your camera, carefully choose an appropriate location. Normally, levels are installed on the back of the camera to allow you to level the camera film plane, front to rear, left to right. Again, carefully choose a location that is convenient, easily seen and will not interfere with the camera mechanism. Levels may be installed on other parts of the camera, just remember to choose the location carefully.

If you are replacing an existing level you may have to make the opening a little larger to accommodate the new level vial. If this is a new installation, you will need to route the appropriate opening, either way, refer to Figure 1. for suggested opening size. You can use a router with suitable bit, a Dremel<sup>®</sup> Tool or a hand chisel to make the opening. Just remember to measure carefully and take your time.

**NOTE:** *Be certain the routed opening is deep enough to allow the level vial to lay just below the surface of the opening. If the vial protrudes above the surface, it could be pressed out of alignment, or even worse, broken, when the cover plate is screwed into place. If the vial is too far from the surface it will be difficult to see. The optimum placement allows for only a few thousandths of an inch between the vial and the cover plate. **MEASURE CAREFULLY!***

Test fit the level vial in the opening repeatedly, until you are satisfied you have an adequately routed opening. The vial should have some movement in the opening, so it can be adjusted to absolutely

level. Place the camera on a level surface, and using an accurate reference level, adjust the camera so the plane the level vial lies in is exactly level. Once you are satisfied you have the camera truly level, place a small bead of clear silicon glue along the bottom rear edge of the routed opening. Then press the level vial into the opening, making sure the two reference marks painted on the vial are facing up. Now check your reference level to make sure the camera is still level, then check your newly installed vial. Adjust the vial until it is exactly level. . . do this before the silicon glue begins to set. Make sure the vial is just below the surface of the cutout and allow the glue to harden. You will need to check the level vial several times in the first few hours to make sure it doesn't settle out of alignment. Allow the glue to cure overnight.

Once the silicone glue is set, place the brass cover plate over the level vial and carefully align. Mark the two mounting holes and using the 0.0625" drill bit, drill a pilot hole for each mounting screw. Attach the brass plate using the two round head brass screws and you are ready to use your camera.

**SUGGESTION:** *You may want to paint the back of the routed opening with white paint before installing the level vial. This makes the level easier to read. Use a small brush and white model airplane paint available at your local hobby store. Allow the paint to dry thoroughly before gluing the vial into place.*

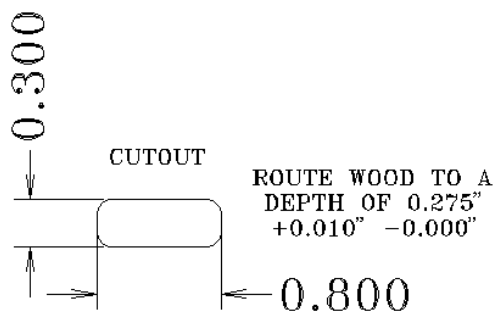

---

---

**J.B. HARLIN**  
**P.O. BOX 26994**  
**BENBROOK, TX 76126**

www.jbhphoto.com  
©2002 all rights reserved